

reflecta Tabula Wall II

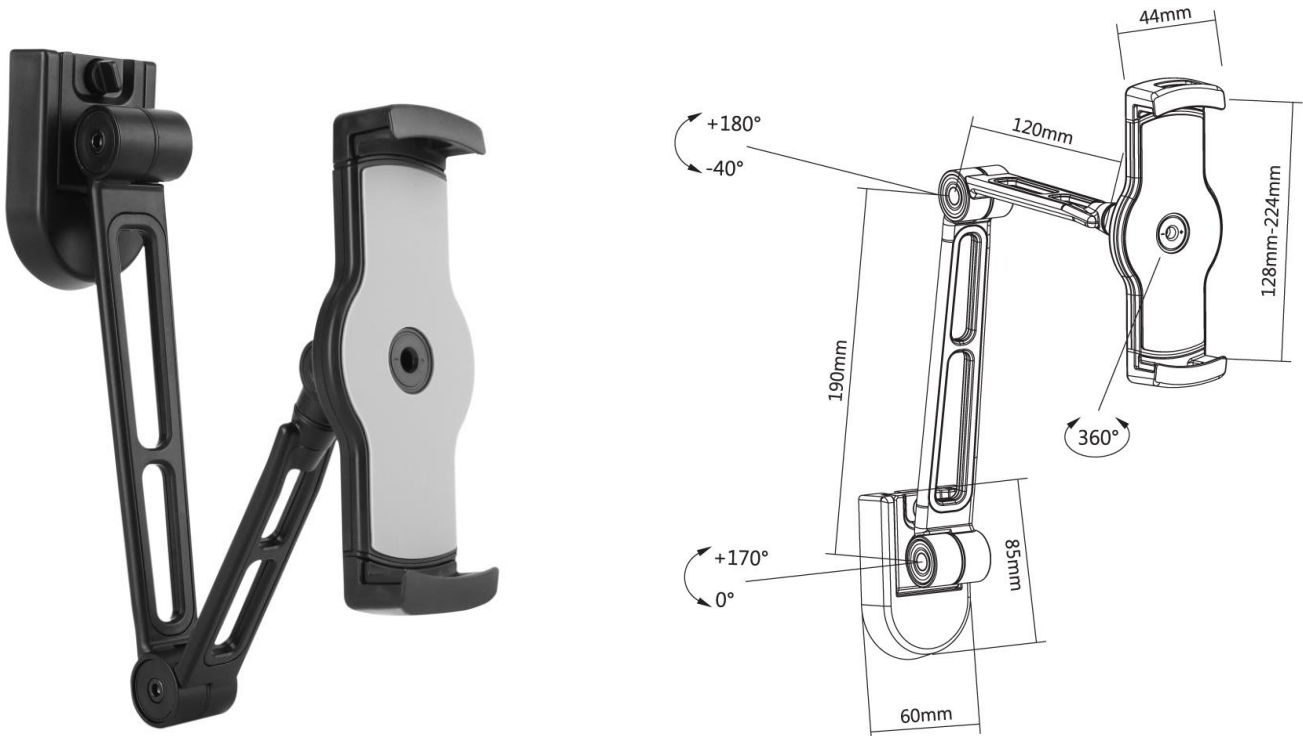

Product information:

- Universal Tablet holder for most 4.7"-12.9" (11,9-32,8 cm) Tablet PCs
- Also compatible with: iPad mini, iPad
- For installation on the wall or under cabinet
- Material: Steel, aluminum, plastic
- Dimensions: 254x107x65mm
- Tilt: 0°~+170°
- Swivel: +180°~-180°
- 360° rotation for portrait & landscape view
- Max. loading weight: 1 kg
- Profile: 72-390mm
- Clamping range: 128-224mm
- Cable management

Art-Nr.: 23237

EAN: 4005039232374

Specifications subject to change without prior notice

reflecta gmbh
 Merkurstrasse 8
 D 72184 Eutingen
 Phone: +49 (0) 7457 9465-60
 Fax: +49 (0) 7457 9465-72
 e-mail: mail@reflecta.de
 http: www.reflecta.de